

Growing Suburbs Fund 2021-22

The Growing Suburbs Fund is a contribution towards meeting critical local infrastructure needs for communities in Melbourne's diverse and fast-growing outer suburbs. It is positioned to quickly respond to the pressures being experienced by interface and peri-urban communities by bringing forward local infrastructure projects that will make a big difference in the day-to-day lives of outer suburban families.

Cardinia Shire Council



Cardinia Shire Council is located on Melbourne's south-east fringe and is about 55 km from the Melbourne Central Business District.

Cardinia Shire Council is part of the interface council area and recorded a growth rate of 3.6% in 2019-20.1 The population is projected to grow from 116,193 in 2020 to about 177,868 or 53.1% per cent by 2036.²

Victoria's population has witnessed a considerable slow-down in growth due to COVID and a pause in overseas migration. This is mostly felt in the inner/middle suburbs of Melbourne but is still evident in outer suburbs.

Main Street Pakenham Revitalisation

Main Street, Pakenham 3810

The Growing Suburbs Fund will assist Cardinia Shire Council to revitalise Main Street in Pakenham.

The Main Street Pakenham Revitalisation project is a first step as an upgrade to the Pakenham Activity Centre and will see the delivery of an improved streetscape and public realm with increased outdoor dining opportunities to assist in stronger social cohesion, and to provide a safe and vibrant space for community to shop, eat, relax, socialise, work and live.

This project will include:

- Straightening Main Street and creating consistent parking spaces to simplify traffic movement
- Increasing the width of the shared path to allow for more on-street trading and active transports
- Upgrading the stormwater infrastructure and introducing additional water sensitive urban design measures
- Increasing and improving the landscape and plantings
- Provisions of street furniture and supporting amenities to provide innovative and integrated shared spaces
- Continuous verandas and awnings to increase shade and weather protection.

Expected date of commencement: October 2022

Expected date of completion: October 2023

Total Project Cost: \$1,090,000

Growing Suburbs Fund: \$1,000,000

Other contributions:

Cardinia Shire Council: \$90,000

¹ ABS Regional Population Growth, March 2022

² Victoria in Future, 2019

The other projects in Cardinia Shire Council to receive funding from the Growing Suburbs Fund 2021-22 are:

- Garfield North Community Centre Cannibal Creek Reserve (\$1,300,00)
- Eastern Dandenong Ranges Trail Connection (\$200,000)

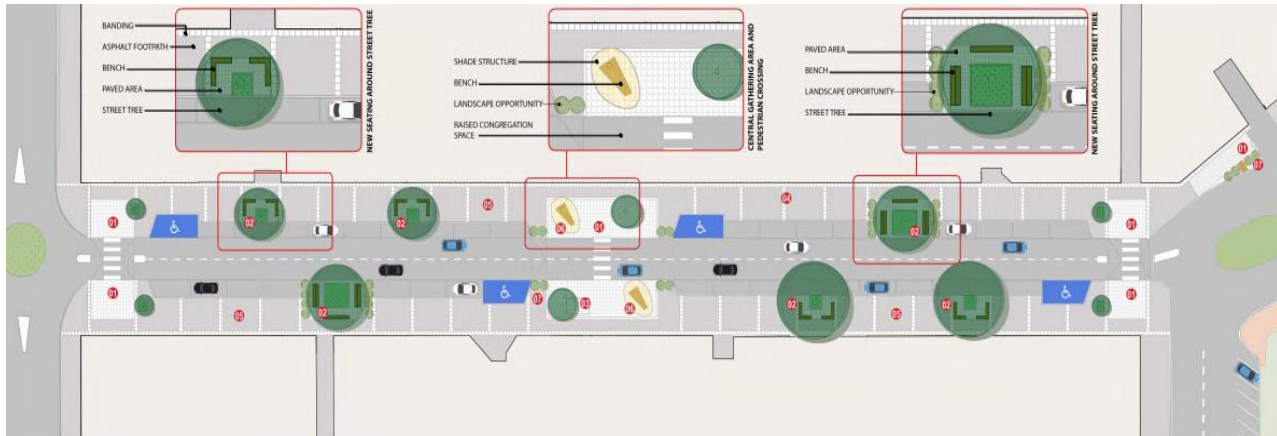

Figure 1: Concept design

You can find out about other Growing Suburbs Fund projects at <https://www.localgovernment.vic.gov.au/grants/growing-suburbs-fund>

For more information regarding these projects contact the GSF team at gsf@ecodev.vic.gov.au

Authorised by the Hon Shaun Leane MP, Minister for Local Government and Suburban Development

Department of Jobs, Precincts and Regions
1 Spring Street Melbourne Victoria 3000
Telephone (03) 9651 9999
© Copyright State of Victoria,
Department of Jobs, Precincts and Regions 2022

Except for any logos, emblems, trademarks, artwork and photography this document is made available under the terms of the Creative Commons Attribution 3.0 Australia license.

This document is also available in an accessible format at djpr.vic.gov.au