

Growing Suburbs Fund 2021-22

The Growing Suburbs Fund is a contribution towards meeting critical local infrastructure needs for communities in Melbourne's diverse and fast-growing outer suburbs. It is positioned to quickly respond to the pressures being experienced by interface and peri-urban communities by bringing forward local infrastructure projects that will make a big difference in the day-to-day lives of outer suburban families.

Melton City Council



Melton City Council is located approximately 40 kilometres west of central Melbourne and is one of the fastest growing interface councils. Strong residential growth is expected to continue, with a number of new suburbs under development.

Melton City Council recorded a growth rate of 4.6% in 2019-20.¹ The population is projected to grow from 172,500 in 2020 to about 332,051 or 92.5% per cent by 2036.²

Victoria's population has witnessed a considerable slow-down in growth due to COVID and a pause in overseas migration. This is mostly felt in the inner/middle suburbs of Melbourne but is still evident in outer suburbs.

¹ ABS Regional Population Growth March 2022

² Victoria in Future, 2019

The Parkway Reserve Upgrade

15 Otway Green, Caroline Springs 3023

The Growing Suburbs Fund will assist Melton City Council to upgrade the Parkway Reserve to better meet the needs and demands of the community.

The Parkway Reserve Upgrade will address the current gaps in accessibility and will deliver an inclusive and diverse open space for the Melton community to enjoy holistic social and physical activity.

The project scope will include:

- Additional play spaces and activity areas linking the new and existing infrastructure
- Upgraded path networks
- Landscaping
- Public amenity infrastructure.

Expected date of commencement: June 2023

Expected date of completion: December 2023

Total Project Cost: \$1,300,000

Growing Suburbs Fund: \$650,000

Other contributions:

- Melton City Council \$650,000

The other projects in Melton City Council to receive funding from the Growing Suburbs Fund 2021-22 are:

- Earlington Square Reserve Upgrade (\$450,000)
- Cobblebank Community Services Hub (\$4,000,000)
- Navan Park Upgrade (\$560,297)
- Bridge Road Recreations Reserve Stage 2 (\$800,000)

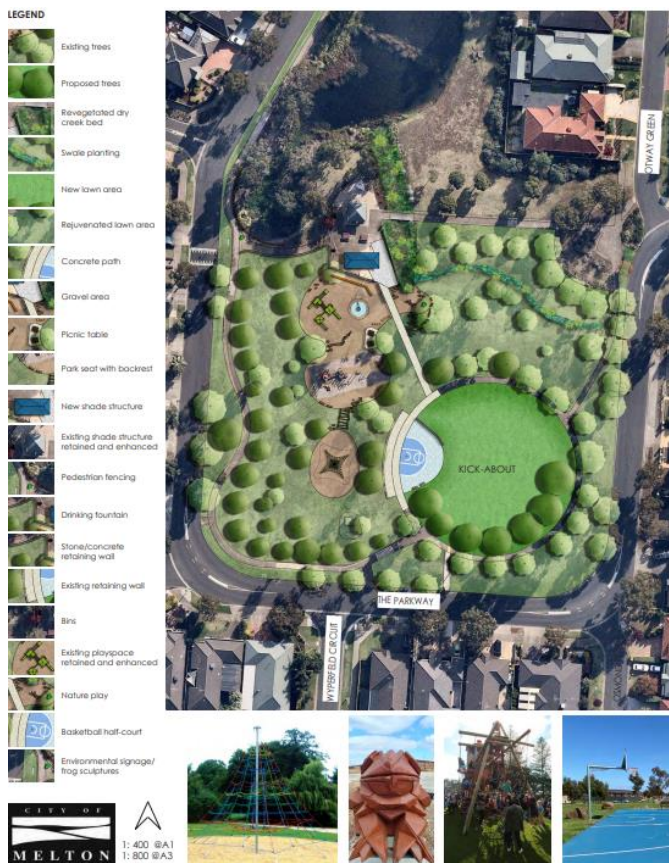

Figure 1: Concept design

You can find out about other Growing Suburbs Fund projects at <https://www.localgovernment.vic.gov.au/grants/growing-suburbs-fund>

For more information regarding these projects contact the GSF team at gsf@ecodev.vic.gov.au

Authorised by the Hon Shaun Leane MP, Minister for Local Government and Suburban Development

Department of Jobs, Precincts and Regions
1 Spring Street Melbourne Victoria 3000
Telephone (03) 9651 9999

© Copyright State of Victoria,
Department of Jobs, Precincts and Regions 2022

Except for any logos, emblems, trademarks, artwork and photography this document is made available under the terms of the Creative Commons Attribution 3.0 Australia license.

This document is also available in an accessible format at dijpr.vic.gov.au