

Growing Suburbs Fund 2021-22

The Growing Suburbs Fund is a contribution towards meeting critical local infrastructure needs for communities in Melbourne's diverse and fast-growing outer suburbs. It is positioned to quickly respond to the pressures being experienced by interface and peri-urban communities by bringing forward local infrastructure projects that will make a big difference in the day-to-day lives of outer suburban families.

Baw Baw Shire Council

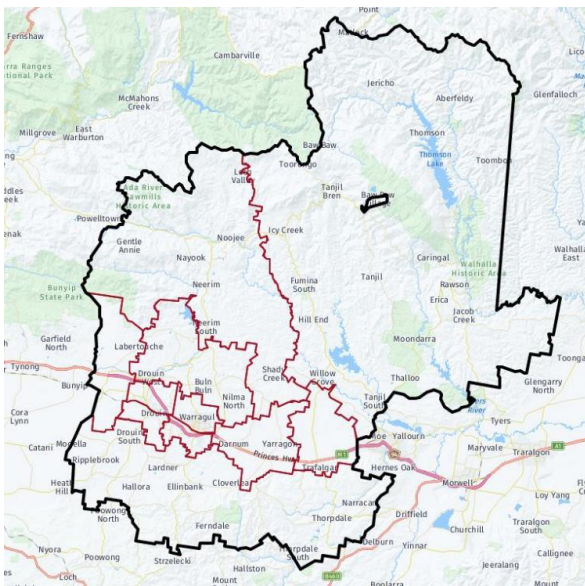

Baw Baw Shire is located in the West Gippsland region of Victoria, about 100 kilometres east of the Melbourne CBD. Baw Baw Shire is bounded by the Yarra Ranges Shire and Mansfield Shire in the north, Wellington Shire and Latrobe City in the east, South Gippsland Shire in the south, and Cardinia Shire in the west.

Known as one of Victoria's peri-urban councils, the area recorded a growth rate of 2.8% in 2019-20.¹ The current population of 54,884 is expected to grow significantly to 75,819 or 38.1% by 2036.²

Victoria's population has witnessed a considerable slow-down in growth due to COVID and a pause in overseas migration. This is mostly felt in the inner/middle suburbs of Melbourne but is still evident in outer suburbs. Regional areas are much less impacted, at least partly due to migration from Melbourne to the regions.

¹ ABS Regional Population Growth March 2022

² Victoria in Future, 2019

Baw Baw Civic Precinct Stage 1

1 Civic Place, Warragul 3820

The Growing Suburbs Fund will assist Baw Baw Shire Council to deliver an innovative community centre.

The Baw Baw Civic Precinct Stage 1 project will provide a new inspiring community building at the edge of the Civic Park in Warragul.

The facility will offer much needed services, programs and opportunities for the local community.

The project will deliver:

- A multi-faceted library
- Co-working spaces
- Café and plaza
- Community rooms
- Roof garden

Expected date of commencement: November 2022

Expected date of completion: February 2024

Total Project Cost: \$30,000,000

Growing Suburbs Fund: \$3,500,000

Other contributions:

- Baw Baw Shire Council: \$10,000,000
- Other funding sources to be confirmed

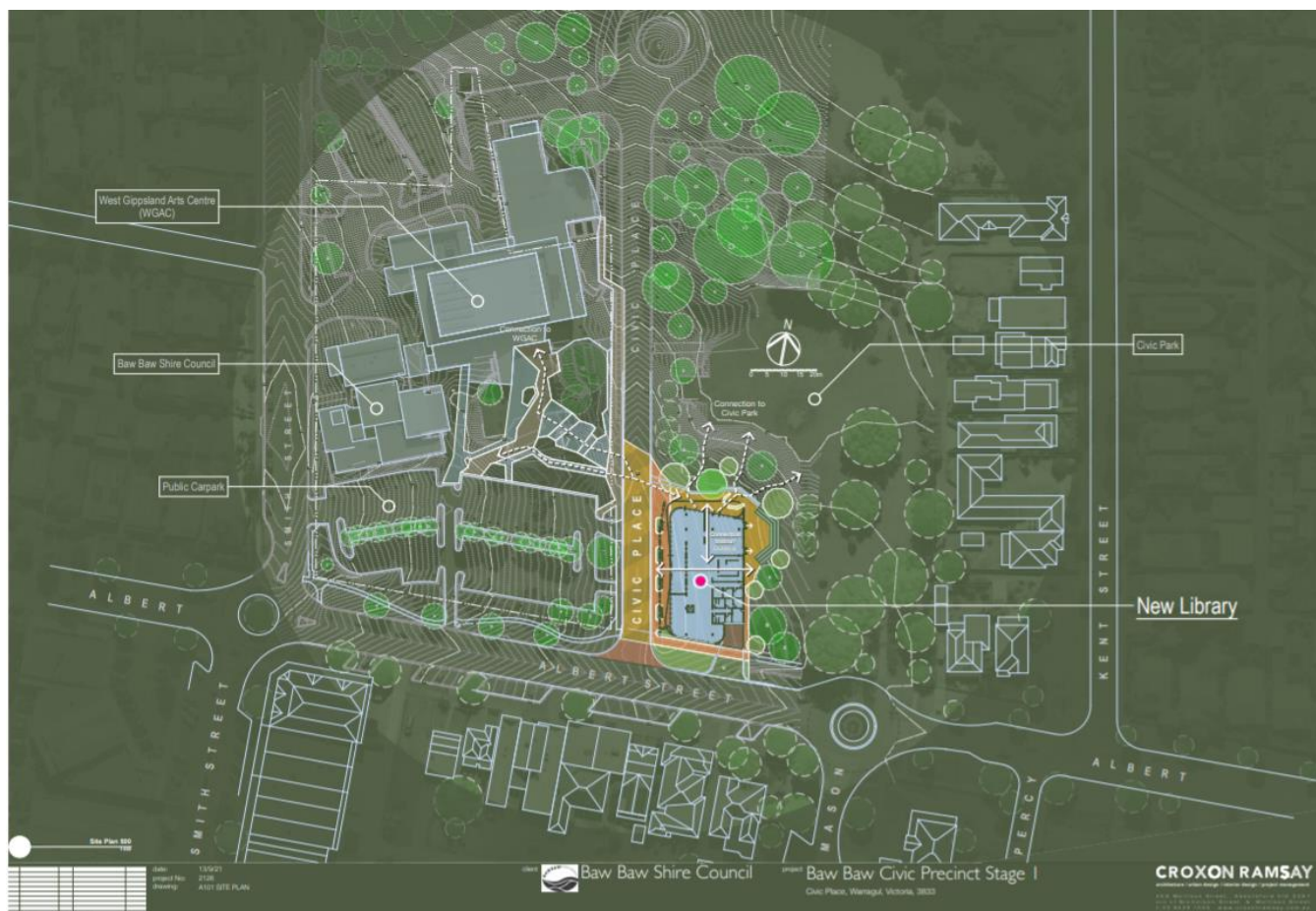

Figure 1: Project site map Croxon Ramsay

You can find out about other Growing Suburbs Fund projects at <https://www.localgovernment.vic.gov.au/grants/growing-suburbs-fund>

For more information regarding these projects contact the GSF team at gsf@ecodev.vic.gov.au

Authorised by the Hon Shaun Leane MP, Minister for Local Government and Suburban Development
Department of Jobs, Precincts and Regions
1 Spring Street Melbourne Victoria 3000
Telephone (03) 9651 9999

© Copyright State of Victoria,

Department of Jobs, Precincts and Regions 2022
Except for any logos, emblems, trademarks, artwork and photography this document is made available under the terms of the Creative Commons Attribution 3.0 Australia license.

This document is also available in an accessible format at djpr.vic.gov.au