

Growing Suburbs Fund 2020-21 Round 2

The Growing Suburbs Fund is a contribution towards meeting critical local infrastructure needs for communities in Melbourne's diverse and fast-growing outer suburbs. It is positioned to quickly respond to the pressures being experienced by interface and peri-urban communities by bringing forward local infrastructure projects that will make a big difference in the day-to-day lives of outer suburban families.

Whittlesea City Council



Whittlesea City Council is located about 20 km north of the Melbourne Central Business District. The southern parts of the city are established urban areas and current residential developments are extending towards the north of the municipality.

Whittlesea City Council is home to an ethnically diverse community, with more than half of the residents from non-English speaking backgrounds. In 2018, the population of Whittlesea City Council grew 3.5 per cent compared with the national average of 1.6 per cent. The population is projected to grow by 63.2 percent from around 223,300 in 2018, to about 364,500 in 2036¹.

WHITTLESEA PUBLIC GARDENS SKATE PARK AND URBAN ZONE

158 Barry Road Lalor 3075

The Growing Suburbs Fund will assist Whittlesea City Council to deliver a district level public open space inclusive of multi-purpose courts and landscaped areas to meet the passive recreation and wellbeing needs of the growing surrounding communities.

The project will include:

- Inviting entry/exit access points with clear view lines through the site inclusive of DDA access paths
- A plaza style skatepark inclusive of beginner, intermediate and advance zones
- Multi-purpose courts and community social gathering spaces inclusive of shade, shelter and public furniture
- A standalone rock-climbing wall
- Landscaping, inclusive of a level change to the western side of the area, spectator lawn areas and raised garden beds for seating and skating opportunities
- A full-size, and a secondary half size basketball court

Expected date of commencement: October 2022

Expected date of completion: April 2023

Total Project Cost: \$1,300,000

Growing Suburbs Fund: \$650,000

Other contributions:

- Whittlesea City Council: \$650,000

¹ Victoria in the Future, 2019

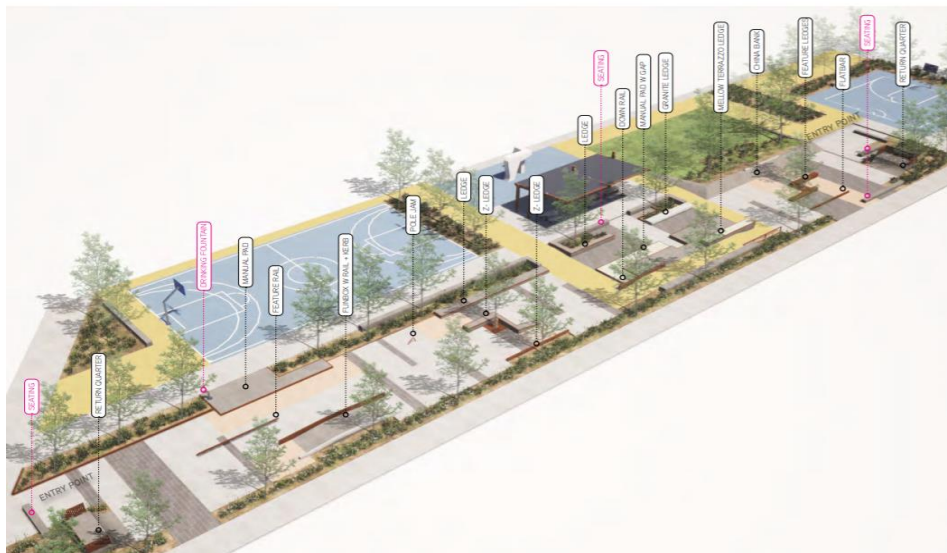

Figure 1: Concept design

The other projects in Whittlesea City Council to receive funding from the Growing Suburbs Fund 2020-21 Round 2 are:

- Kelynack Recreation Reserve Play Space and Multi Play Area Redevelopment (\$675,000)
- Norris Bank Reserve West Precinct (\$600,000)
- Mernda Adventure Park Public Amenity (\$150,000)
- Redleap Recreation Reserve Upgrade (\$525,000)

You can find out about other Growing Suburbs Fund projects at <https://www.localgovernment.vic.gov.au/grants/growing-suburbs-fund>

For more information regarding these projects contact the GSF team at gsf@ecodev.vic.gov.au

Authorised by the Hon Shaun Leane MP, Minister for Local Government and Suburban Development

Department of Jobs, Precincts and Regions
 1 Spring Street Melbourne Victoria 3000
 Telephone (03) 9651 9999
 © Copyright State of Victoria,
 Department of Jobs, Precincts and Regions 2019

Except for any logos, emblems, trademarks, artwork and photography this document is made available under the terms of the Creative Commons Attribution 3.0 Australia license.

This document is also available in an accessible format at djpr.vic.gov.au