

The Growing Suburbs Fund is a contribution towards meeting critical local infrastructure needs for communities in Melbourne's diverse and fast-growing outer suburbs. It is positioned to quickly respond to the pressures being experienced by interface communities by bringing forward local infrastructure projects that will make a big difference in the day-to-day lives of outer suburban families.

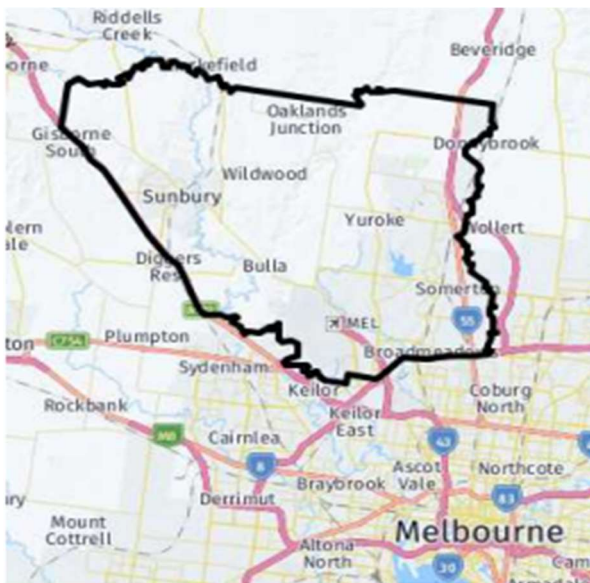

Hume City Council is a growing, urban fringe municipality about 20 km from the Melbourne Central Business District. The southern parts of the city are well-established urban areas while the north remains rural in character. It has a young population, with 31 per cent of residents under 18 years of age.

Hume City Council is experiencing significant growth at a rate of 3.9 per cent - outstripping the national average growth rate of 1.6 per cent. The resident population in Hume City Council is estimated at 215,930 (2017) and is forecasted to grow by 36 per cent, to about 294,000 by 2031.¹

CRAIGIEBURN SOFTBALL CENTRE

18 Rhyolite Drive, Craigieburn 3064

Background: The development of the Craigieburn Softball Centre is a \$5 million partnership project between Hume City Council and the Victorian Government. The 2018-19 Growing Suburbs Fund will contribute \$1.5 million and Hume City Council will provide \$3.5 million towards this project.

The construction of the Craigieburn Softball Centre will provide the Craigieburn community with a new and diverse open space and will support active and passive recreation activities to improve the health and wellbeing of the community.

Softball is increasing in popularity in Craigieburn and currently the Craigieburn Eagles Softball Club, formed four years ago, has seven teams with members as young as 8 years old with majority of them being female. This project will provide female participants with equitable access to facilities as the more traditional male dominated sports.

The project will include the construction of two softball fields with sports lighting, construction of a multipurpose open space that can accommodate two additional softball fields, pavilion (stage 2), new place space and walking paths and landscapes. The pavilion at the reserve will provide space for community members to meet and to run programs and activities which is vital for a growing community needs in the new Craigieburn.

¹ Victoria in the Future, 2016 <http://profile.id.com.au/hume>

GROWING SUBURBS FUND 2018-19

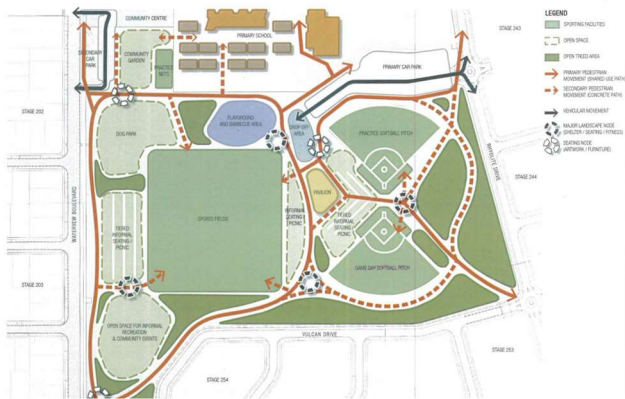

Figure 1: Site layout

Hume City Council will receive a total of \$5,781,891 for six projects under the Growing Suburbs Fund 2018/19 Round.

Growing Suburbs Fund contributes to a mix of infrastructure projects that have a direct benefit to communities living in the outer suburbs.

You can find out about other Growing Suburbs Fund Projects at localgovernment.vic.gov.au/gsf

For more information regarding these projects contact Local Infrastructure, DELWP.

Email: gsf@delwp.vic.gov.au or phone: 9948 8536

Expected date of commencement: September 2019

Expected date of completion: May 2022

Total Project Cost: \$5,000,000

Growing Suburbs Fund: \$1,500,000

Other contributions: Hume City Council contributes \$3,500,000

Other projects in Hume City Council to receive funding from the 2018/19 Growing Suburbs Fund are:

- Bulla Village Tennis Club Community Pavilion (\$300,000)
- Galaxyland Playspace Redevelopment (\$500,000)
- Hume Tennis and Community Centre Playspace (\$450,000)
- Cloverton South Community Hub (\$2,656,891)
- Connecting Sunbury Town Centre (\$375,000)

© The State of Victoria Department of Environment, Land, Water and Planning 2020



This work is licensed under a Creative Commons Attribution 4.0 International licence. You are free to re-use the work under that licence, on the condition that you credit the State of Victoria as author. The licence does not apply to any images, photographs or branding, including the Victorian Coat of Arms, the Victorian Government logo and the Department of Environment, Land, Water and Planning (DELWP) logo. To view a copy of this licence, visit <http://creativecommons.org/licenses/by/4.0/>

ISBN 978-1-76077-985-6 (pdf/online)

Disclaimer

This publication may be of assistance to you but the State of Victoria and its employees do not guarantee that the publication is without flaw of any kind or is wholly appropriate for your particular purposes and therefore disclaims all liability for any error, loss or other consequence which may arise from you relying on any information in this publication.

Accessibility

If you would like to receive this publication in an alternative format, please telephone the DELWP Customer Service Centre on 136186, email customer.service@delwp.vic.gov.au, or via the National Relay Service on 133 677 www.relayservice.com.au. This document is also available on the internet at www.delwp.vic.gov.au.