

GROWING SUBURBS FUND 2019-20

WHITTLESEA CITY COUNCIL

The Growing Suburbs Fund is a contribution towards meeting critical local infrastructure needs for communities in Melbourne's diverse and fast-growing outer suburbs. It is positioned to quickly respond to the pressures being experienced by interface communities by bringing forward local infrastructure projects that will make a big difference in the day-to-day lives of outer suburban families.



Whittlesea City Council is located about 20 km north of the Melbourne Central Business District. The southern parts of the city are established urban areas and current residential developments are extending towards the north of the municipality.

Whittlesea City Council is home to an ethnically-diverse community, with more than half of the residents from non-English speaking backgrounds. In 2018, the population of Whittlesea City Council grew 3.5 per cent compared with the national average of 1.6 per cent. The population is projected to grow by 63.2 percent from around 223,300 in 2018, to about 364,500 in 2036.¹

WHITTLESEA COMMUNITY SKATE PARK

35C Beech Street, Whittlesea 3757

Background: The Growing Suburbs Fund will assist Whittlesea City Council to upgrade the Whittlesea skate park to provide updated facilities and reinvigorate the reserve and significantly increase the number of visitors to an already popular park.

The project will include:

- street skate and park elements
- new social and seating spaces
- a refurbished BMX track
- shade structures and drinking fountains
- pathways connecting Beech Street to Laurel Street.

The Skate Park is located centrally to other recreation facilities and it is 400 metres from Whittlesea's Town Centre. The project will improve accessibility to cater for a broader range of age groups, encourage female participation, and skaters of different abilities, for the growing Whittlesea community.

¹ Victoria in the Future, 2019



Growing Suburbs Fund

delwp.vic.gov.au



Environment,
Land, Water
and Planning

GROWING SUBURBS FUND 2019-20



Figure 1: Existing conditions (Whittlesea City Council)

Expected date of commencement: July 2020

Expected date of completion: November 2021

Total Project Cost: \$950,000

Growing Suburbs Fund: \$375,000

Other contributions:

Whittlesea City Council \$575,000

Growing Suburbs Fund contributes to a mix of infrastructure projects that have a direct benefit to communities living in the outer suburbs.

Other projects in the Whittlesea City Council to receive funding from the 2019-20 Growing Suburbs Fund are:

- Quarry Hills Regional Parkland (\$2,500,000)
- Whittlesea Public Gardens Revitalisation (\$2,000,000)
- Lalor Streetscape Upgrade (\$1,500,000)
- McLeans Road Kindergarten Upgrade (\$500,000)

Whittlesea City Council received a total of \$6,875,000 million for five projects under the Growing Suburbs Fund 2019-2020.

WHITTLESEA SKATE AND BMX PARK IMPROVEMENTS

SAFE - INCLUSIVE - MULTI-FUNCTIONAL

- A Upgrade and expand the existing Skate Park with integrated Basketball Half Court**
Investigate potential of expanding upon existing skate facility or providing entirely new skate facility. This should integrate a basketball half court, to increase uses within the space.
- B Improve path network**
Realign and formalise path network to ensure passive surveillance, sight lines and safety are maximised. Integrate trees along the path to improve shade and amenity.
- C Upgrade existing BMX track**
BMX track is in disrepair and requires upgrading and improvements.
- D New social spaces**
Investigate potential of providing 1 or 2 social spaces one close to the existing road with better passive surveillance and 1 in a high point between the skate and BMX park, encouraging more connections between the two activities and their associated communities.
- E Increase trees and improve canopy cover**
Improve canopy cover in the area and investigate potential ways to include this within the skate park layout for improved shade and amenity.
- F Improve upon creek interface and planting**
Seek ways to improve upon creek amenity and planting.

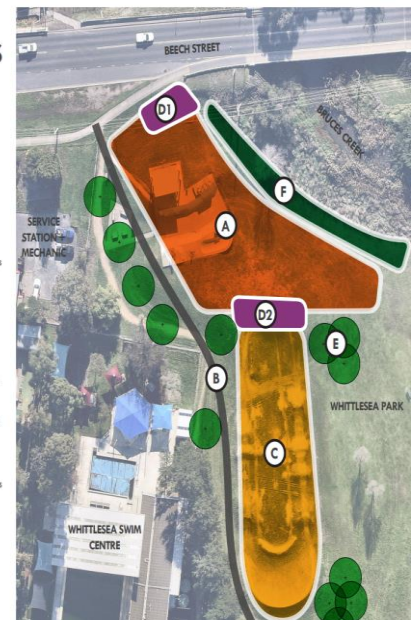

Figure 2: Concept Plan (Whittlesea City Council)

You can find out about other Growing Suburbs Fund Projects at localgovernment.vic.gov.au/gsf

For more information regarding these projects contact Local Infrastructure, DELWP.

Email: gsf@delwp.vic.gov.au or phone: 9948 8536

© The State of Victoria Department of Environment, Land, Water and Planning 2020



This work is licensed under a Creative Commons Attribution 4.0 International licence. You are free to re-use the work under that licence, on the condition that you credit the State of Victoria as author. The licence does not apply to any images, photographs or branding, including the Victorian Coat of Arms, the Victorian Government logo and the Department of Environment, Land, Water and Planning (DELWP) logo. To view a copy of this licence, visit <http://creativecommons.org/licenses/by/4.0/>

ISBN 978-1-76105-097-8 (pdf/online/MS word)

Disclaimer

This publication may be of assistance to you but the State of Victoria and its employees do not guarantee that the publication is without flaw of any kind or is wholly appropriate for your particular purposes and therefore disclaims all liability for any error, loss or other consequence which may arise from you relying on any information in this publication.

Accessibility

If you would like to receive this publication in an alternative format, please telephone the DELWP Customer Service Centre on 136186, email customer.service@delwp.vic.gov.au, or via the National Relay Service on 133 677 www.relayservice.com.au. This document is also available on the internet at www.delwp.vic.gov.au.