

The Growing Suburbs Fund is a contribution towards meeting critical local infrastructure needs for communities in Melbourne's diverse and fast-growing outer suburbs. It is positioned to quickly respond to the pressures being experienced by interface communities by bringing forward local infrastructure projects that will make a big difference in the day-to-day lives of outer suburban families.



### ELTHAM NORTH ADVENTURE PLAYGROUND ENHANCEMENT

The Parade off Wattletree Road, Eltham North 3095

**Background:** The Growing Suburbs Fund will partner with Nillumbik Shire Council to enhance the Eltham North Adventure Playground with the installation of play, picnic, amenity plantings and circulation infrastructure at the Eltham North. Perimeter play elements that connect the play space with the adjoining natural landscape environments will allow for calm, reflective play away from the energy of the main play space. Elements will include

- a dry creek bed
- interactive water features
- picnic shelters, BBQs, tables and drinking taps
- perimeter pathways
- landscaping
- car park enhancements - asphaltting disabled car parking bay, line marking, bollards, upgrading car park surface
- signage
- interactive public art installation

**Expected date of commencement:** March 2019

**Expected date of completion:** August 2019

Nillumbik Shire Council is located 25 km North-east of the Melbourne Central Business District, and the southern boundary is the Yarra River. It is predominantly urban to the South while the north of the municipality includes significant features like the Kinglake National Park and Sugarloaf Reservoir. In 2017, Nillumbik Shire recorded an annual resident population growth rate of 0.7 per cent, of 65,000 residents<sup>1</sup>.

The population is forecasted to grow to 68,000, by 4 per cent, by 2031.

<sup>1</sup> Victoria in the Future, 2016 <http://profile.id.com.au/nillumbik>

# GROWING SUBURBS FUND 2018-19

Total Project Cost: \$919,048

Growing Suburbs Fund: \$569,641

Other contributions: Nillumbik Shire Council \$349,407

You can find out about other Growing Suburbs Fund Projects at [localgovernment.vic.gov.au/gsf](http://localgovernment.vic.gov.au/gsf)

For more information regarding these projects contact Local Infrastructure, DELWP.

Email: [gsf@delwp.vic.gov.au](mailto:gsf@delwp.vic.gov.au) or phone: 9948 8536

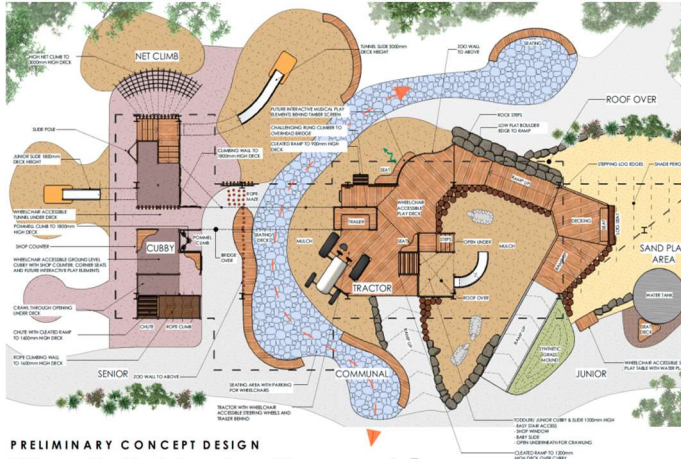

Growing Suburbs Fund contributes to a mix of infrastructure projects that have a direct benefit to communities living in the outer suburbs.

Figure 1 – Location of the Project site and Project zones

Other projects in Nillumbik Shire Council to receive funding from the 2018/19 Growing Suburbs Fund are:

- Greensborough Hockey Multi-Purpose Pavilion Redevelopment (\$2,000,000)
- Diamond Creek Regional Park-Playspace (PlayLink) (\$2,500,000)

Nillumbik Shire Council will receive a total of \$5,069,641 for three projects under the Growing Suburbs Fund 2018-19 Round.

© The State of Victoria Department of Environment, Land, Water and Planning 2020



This work is licensed under a Creative Commons Attribution 4.0 International licence. You are free to re-use the work under that licence, on the condition that you credit the State of Victoria as author. The licence does not apply to any images, photographs or branding, including the Victorian Coat of Arms, the Victorian Government logo and the Department of Environment, Land, Water and Planning (DELWP) logo. To view a copy of this licence, visit <http://creativecommons.org/licenses/by/4.0/>

ISBN 978-1-76047-987-9 (pdf/online)

#### Disclaimer

This publication may be of assistance to you but the State of Victoria and its employees do not guarantee that the publication is without flaw of any kind or is wholly appropriate for your particular purposes and therefore disclaims all liability for any error, loss or other consequence which may arise from you relying on any information in this publication.

#### Accessibility

If you would like to receive this publication in an alternative format, please telephone the DELWP Customer Service Centre on 136186, email [customer.service@delwp.vic.gov.au](mailto:customer.service@delwp.vic.gov.au), or via the National Relay Service on 133 677 [www.relayservice.com.au](http://www.relayservice.com.au). This document is also available on the internet at [www.delwp.vic.gov.au](http://www.delwp.vic.gov.au).