

The Growing Suburbs Fund is a contribution towards meeting critical local infrastructure needs for communities in Melbourne's diverse and fast-growing outer suburbs. It is positioned to quickly respond to the pressures being experienced by interface communities by bringing forward local infrastructure projects that will make a big difference in the day-to-day lives of outer suburban families.



Whittlesea City Council is located about 20 km north of the Melbourne Central Business District. The southern parts of the city are established urban areas and current residential developments are extending towards the north of the municipality.

Whittlesea City Council is home to an ethnically-diverse community, with more than half of the residents from non-English speaking backgrounds. In 2018, the population of Whittlesea City Council grew 3.5 per cent compared with the national average of 1.6 per cent. The population is projected to grow by 63.2 percent from around 223,300 in 2018, to about 364,500 in 2036.¹

WHITTLESEA PUBLIC GARDENS REVITALISATION

158 Barry Road, Lalor 3075

Background: The Growing Suburbs Fund will assist Whittlesea City Council to deliver Stage 1 of the Revitalisation to bring the Gardens up to major community and regional park standards. This will provide a recreation asset of regional significance for the Lalor and surrounding communities.

This stage of the revitalisation includes:

- an accessible play space for all ages
- social gathering spaces with seating and shade
- Changing Places and other public amenities
- safe and accessible pathways.

The Whittlesea Public Gardens is one of the most significant and one of the few passive recreation spaces within the Lalor, Thomastown, Epping, and Campbellfield corridor. The Whittlesea Public Gardens provides the only purpose built Regional Open Space for passive recreation or socialising. As identified in the Whittlesea Public Gardens Master Plan, this project will meet the demand of current residents, while also meeting the needs of the projected significant population growth within the corridor. It will provide for broader and more inclusive participation, improve access for children and adults with disabilities, many of whom currently experience difficulties in accessing quality public open space and the benefits that it provides.

¹ Victoria in the Future, 2019



GROWING SUBURBS FUND 2019-20

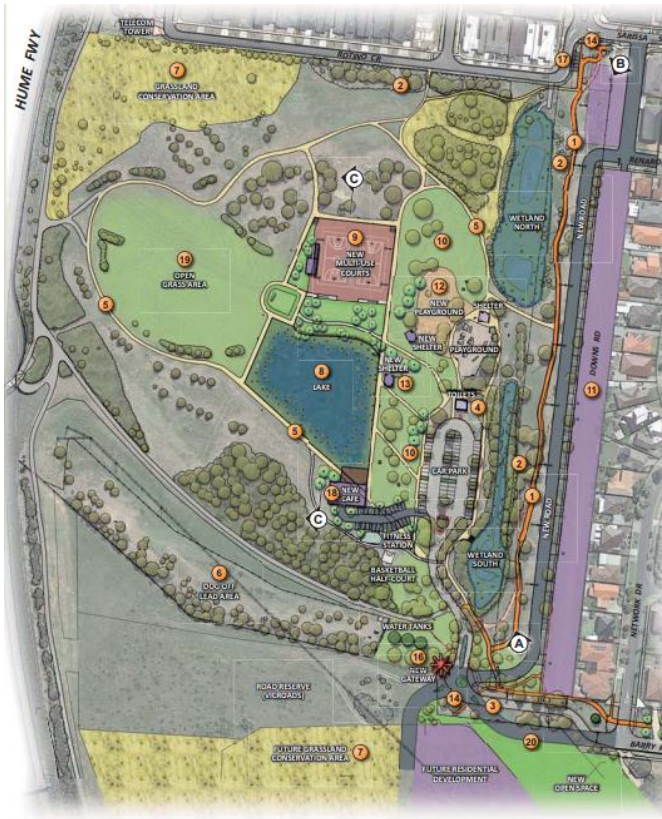

Figure 1: Whittlesea Public Gardens Master Plan Concept (Whittlesea City Council)

Expected date of commencement: June 2020

Expected date of completion: December 2022

Total Project Cost: \$4,000,000

Growing Suburbs Fund: \$2,000,000

Other contributions:

Whittlesea City Council \$2,000,000

Other projects in the Whittlesea City Council to receive funding from the 2019-20 Growing Suburbs Fund are:

- Quarry Hills Regional Parkland (\$2,500,000)
- Whittlesea Community Skate Park Activation (\$375,000)
- Lalor Streetscape Upgrade (\$1,500,000)
- McLeans Road Kindergarten Upgrade (\$500,000)

Whittlesea City Council received a total of \$6,875,000 million for five projects under the Growing Suburbs Fund 2019-2020.

Growing Suburbs Fund contributes to a mix of infrastructure projects that have a direct benefit to communities living in the outer suburbs.

You can find out about other Growing Suburbs Fund Projects at localgovernment.vic.gov.au/gsf

For more information regarding these projects contact Local Infrastructure, DELWP.

Email: gsf@delwp.vic.gov.au or phone: 9948 8536

© The State of Victoria Department of Environment, Land, Water and Planning 2020



This work is licensed under a Creative Commons Attribution 4.0 International licence. You are free to re-use the work under that licence, on the condition that you credit the State of Victoria as author. The licence does not apply to any images, photographs or branding, including the Victorian Coat of Arms, the Victorian Government logo and the Department of Environment, Land, Water and Planning (DELWP) logo. To view a copy of this licence, visit <http://creativecommons.org/licenses/by/4.0/>

ISBN 978-1-76105-099-2 (pdf/online/MS word)

Disclaimer

This publication may be of assistance to you but the State of Victoria and its employees do not guarantee that the publication is without flaw of any kind or is wholly appropriate for your particular purposes and therefore disclaims all liability for any error, loss or other consequence which may arise from you relying on any information in this publication.

Accessibility

If you would like to receive this publication in an alternative format, please telephone the DELWP Customer Service Centre on 136186, email customer.service@delwp.vic.gov.au, or via the National Relay Service on 133 677 www.relayservice.com.au. This document is also available on the internet at www.delwp.vic.gov.au.