

The Growing Suburbs Fund is a contribution towards meeting critical local infrastructure needs for communities in Melbourne's diverse and fast-growing outer suburbs. It is positioned to quickly respond to the pressures being experienced by interface communities by bringing forward local infrastructure projects that will make a big difference in the day-to-day lives of outer suburban families.

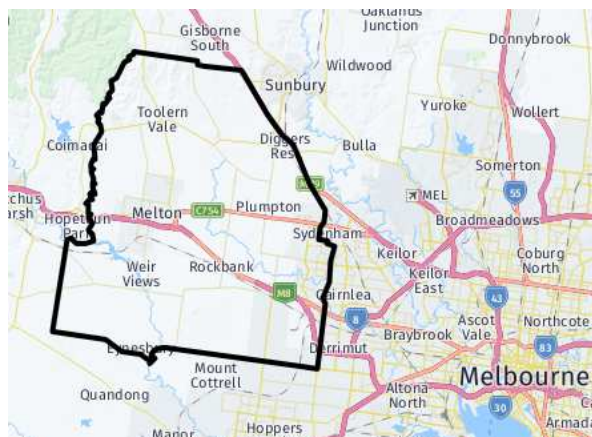

The City of Melton is located approximately 40 kilometres west of central Melbourne and is considered one of the fastest growing interface councils. In 2017, the City of Melton had a growth rate of 5 per cent compared with the national average growth of 1.6 per cent. It is anticipated that Melton's population will more than double between 2017 and 2041¹. Strong residential growth is expected to continue, with a number of new suburbs such as Aintree, Fraser Rise and Hillside currently under development.

¹ Victoria in the Future, 2014 <http://profile.id.com.au/melton>

BILL CAHILL RESERVE UPGRADE

Hume Avenue, Melton South VIC 3338

Project Description: The Growing Suburbs Fund will help the City of Melton bring changes and improve connectivity in the Bill Cahill Reserve at Melton South. This project will enhance the liveability of the neighbourhood and provide a recreational and social midpoint for the local community.

The Bill Cahill Reserve upgrade will include:

- Picnic facilities and furniture
- A new, accessible playground with a variety of equipment and natural play elements
- Large kick-about area with multipurpose goals
- A walking circuit linking to neighbouring streets
- Static exercise equipment
- A band of large native trees to provide shade in the new local forest.



GROWING SUBURBS FUND 2017-18

Expected completion: April 2019

Total Project Cost: \$600,000

Growing Suburbs Fund: \$300,000

Other Contribution:

- **City of Melton \$300,000**

Other project in the City of Melton to receive funding from the 2017-18 Growing Suburbs Fund:

- **Aintree Community Hub (\$1,000,000)**
- **Allenby Road Reserve Upgrade (\$300,000)**
- **Arnolds Creek Playspace (\$300,000)**
- **Fraser Rise Community Hub (\$1,600,000)**
- **Hannah Watts Park Upgrade (\$600,000)**
- **MacPherson Park Redevelopment (\$2,000,000)**
- **Melton Central Community Centre Redevelopment (\$2,000,000)**

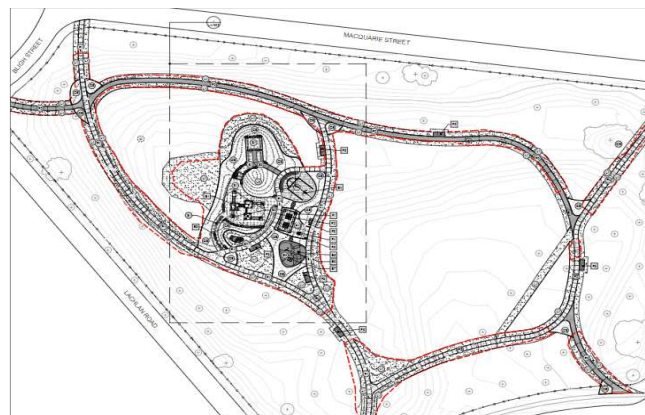

Figure 1: Bill Cahill Reserve Upgrade – Concept Design

(Source: City of Melton)

You can find out about other Growing Suburbs Fund Projects at localgovernment.vic.gov.au/gsf

For more information regarding these projects contact Local Infrastructure, DELWP.
Email: gsf@delwp.vic.gov.au or phone: 9948 8536

Growing Suburbs Fund contributes to a mix of infrastructure projects that have a direct benefit to communities living in the outer suburbs.

© The State of Victoria Department of Environment, Land, Water and Planning 2018



This work is licensed under a Creative Commons Attribution 4.0 International licence. You are free to re-use the work under that licence, on the condition that you credit the State of Victoria as author. The licence does not apply to any images, photographs or branding, including the Victorian Coat of Arms, the Victorian Government logo and the Department of Environment, Land, Water and Planning (DELWP) logo. To view a copy of this licence, visit <http://creativecommons.org/licenses/by/4.0/>

ISBN 978-1-76077-384-7 Online(pdf)

Disclaimer

This publication may be of assistance to you but the State of Victoria and its employees do not guarantee that the publication is without flaw of any kind or is wholly appropriate for your particular purposes and therefore disclaims all liability for any error, loss or other consequence which may arise from you relying on any information in this publication.

Accessibility

If you would like to receive this publication in an alternative format, please telephone the DELWP Customer Service Centre on 136186, email customer.service@delwp.vic.gov.au or gsf@delwp.vic.gov.au or via the National Relay Service on 133 677 www.relayservice.com.au. This document is also available on the internet at www.delwp.vic.gov.au